

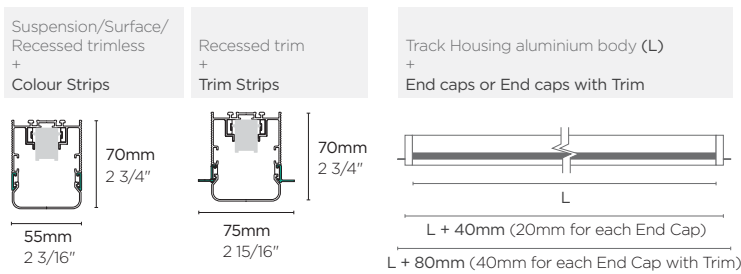

# i55 half profile

INFINITY 2.0 SPECIFICATIONS

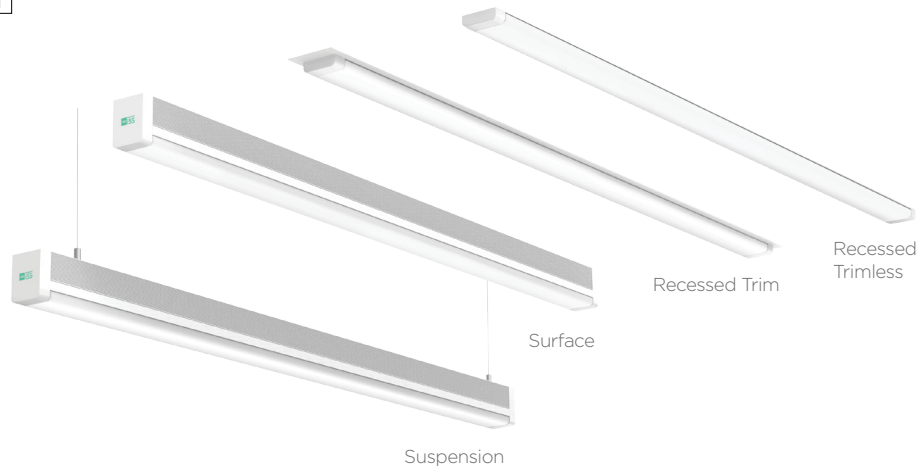

## Track Housing Module

Model	Length(mm/inch)	Weight(kg)	Lamp types	IP	Material
i55HT-600	600 23 5/8"	0.80			
i55HT-700	700 27 9/16"	0.94			
i55HT-800	800 31 1/2"	1.08			
i55HT-900	900 35 7/16"	1.22			
i55HT-1000	1000 39 3/8"	1.36	1. Simple	IP20	Track Housing: Anodized aluminium  Diffuser: Polycarbonate
i55HT-1100	1100 43 5/16"	1.50	2. Smart Cocktail*		
i55HT-1200	1200 47 1/4"	1.64			
i55HT-2400	2400 94 1/2"	3.28			
i55HT-90H	635 x 635 25"x25"	1.68			
i55HT-90V	635 x 635 25"x25"	1.68			

\*Available 3rd quarter of 2016.

1200mm  
Luminous Intensity Distribuion Diagram

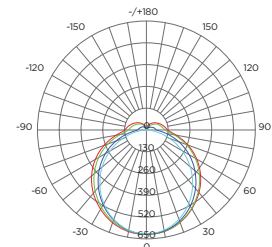

1200mm

Colour Temp.	Wattage	Lumen	Efficacy	CRI
3000K	22W	2008 lm	88 lm/W	Ra≥80
4000K	22W	1949 lm	88 lm/W	Ra≥80
5700K	22W	2274 lm	104 lm/W	Ra≥80

# lamp modules

INFINITY 2.0 SPECIFICATIONS

## Lamp Module

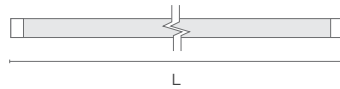
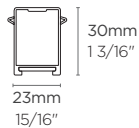
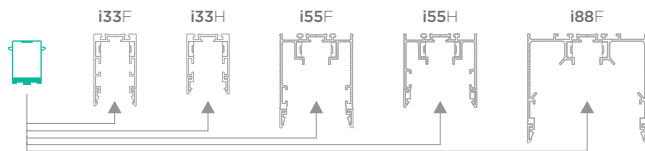

## Simple



Model	Length(mm/inch)	Weight(kg)	Wattage(W)	Colour Temp.	CRI	Voltage	Material
L-600-12W -30/40/57	598 23 9/16"	0.26	12				
L-700-14W -30/40/57	698 27 1/2"	0.30	14				
L-800-16W -30/40/57	798 31 7/16"	0.32	16	3000K 30	Ra≥80	100-240VAC (Voltage Range: 85-264VAC), 50-60Hz	Aluminium, Polycarbonate
L-900-18W -30/40/57	898 35 3/8"	0.36	18	4000K 40			
L-1000-20W -30/40/57	998 39 5/16"	0.38	20	5700K 57			
L-1100-21W -30/40/57	1098 43 1/4"	0.42	21				
L-1200-22W -30/40/57	1198 47 3/16"	0.44	22				

Ex) 900mm, 4000K: L-900-18W-40

## Smart Cocktail\*

\*Available 3rd quarter of 2016.



Model	Length(mm/inch)	Weight(kg)	Wattage(W)	Light adjustability	CRI	Voltage	Material
L-600-14W-SC	598 23 9/16"	0.26	14				
L-700-16W-SC	698 27 1/2"	0.30	16				
L-800-18W-SC	798 31 7/16"	0.32	18	RGB colours (16million), Warm-Cool (3000K-6500K), Dimming.	Ra≥80	100-277VAC (Voltage Range: 85-305VAC), 50-60Hz	Aluminium, Polycarbonate
L-900-21W-SC	898 35 3/8"	0.36	21				
L-1000-24W-SC	998 39 5/16"	0.38	24				
L-1100-26W-SC	1098 43 1/4"	0.42	26				
L-1200-28W-SC	1198 47 3/16"	0.44	28				

Ex) 900mm: L-900-21W-SC

# common accessories

## INFINITY 2.0 SPECIFICATIONS

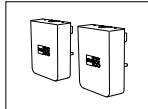

### i55 Half End cap

Model	Colour	Material
i55HE-WHT	White	
i55HE-BLK	Black	PC
i55HE-GRY	Gray	

**Note:**

- Sold in pairs.
- 1 pair required for every light line.
- Includes all hardware to connect to Track Housing.

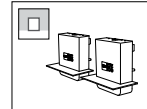

### i55 Half End cap with Trim

Model	Colour	Material
i55HET-WHT	White	
i553HET-BLK	Black	PC
i55HET-GRY	Gray	

**Note:**

- Sold in pairs.
- 1 pair required for every light line.
- Includes all hardware to connect to Track Housing.
- Only used for recessed installation.

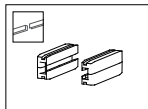

### AC Mid-Connector

Model	Material
ACMC	PC

**Note:**

- Sold in pairs.
- 1 pair required for every Track Housing connection.

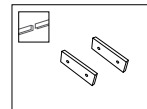

### Linear Track Housing Connector

Model	Material
THC	AL

**Note:**

- Sold in pairs.
- 1 pair required for every Track Housing connection.
- Includes all hardware to connect to Track Housing.

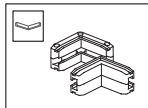

### 90° Horizontal AC Mid-Connector

Model	Material
ACMC-90H	PC

**Note:**

- Sold in pairs.
- 1 pair required for every 90° Horizontal Track Housing connection.
- 1 pair included with 90° Track Housing Module.

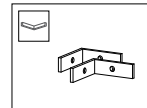

### 90° Horizontal Track Housing Connector

Model	Material
THC-90H	AL

**Note:**

- Sold in pairs.
- 1 pair required for every 90° Horizontal Track Housing connection.
- Includes all hardware to connect to Track Housing.
- 1 pair included with 90° Track Housing Module.

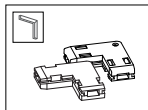

### 90° Vertical AC Mid-Connector

Model	Material
ACMC-90V	PC

**Note:**

- Sold in pairs.
- 1 pair required for every 90° Vertical Track Housing connection.
- 1 pair included with 90° Track Housing Module.

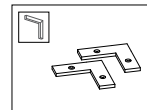

### 90° Vertical Track Housing Connector

Model	Material
THC-90V	AL

**Note:**

- Sold in pairs.
- 1 pair required for every 90° Vertical Track Housing connection.
- Includes all hardware to connect to Track Housing.
- 1 pair included with 90° Track Housing Module.

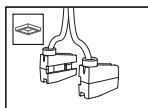

### Closed Loop Layout AC Mid-Connector

Model	Material
ACMC-CLL	PC

**Note:**

- Sold in pairs.
- Used for AC connection to closed loop Track Housing layouts (refer to Infinity installation or system guide for more details).
- Only to be used for suspension and surface installation.
- Recessed installation is not available for closed loop layout.

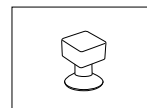

### Track Housing Diffuser Removal Tool

Model	Material
THD-RT	Silicon

# common accessories colour strips

INFINITY 2.0 SPECIFICATIONS

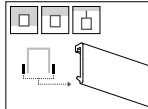

## Track Housing Colour Strip

Model	Length(mm/inch)	Colour	Material
THCS-600- colour code	600 23 5/8"		
THCS-700- colour code	700 27 9/16"		
THCS-800- colour code	800 31 1/2"	White(WHT) Black(BLK)	PC
THCS-900- colour code	900 35 7/16"	Gray(GRY)	
THCS-1000- colour code	1000 39 3/8"	Green(GRN)	
THCS-1100- colour code	1100 43 5/16"	Product code example: THCS-600- <u>WHT</u>	
THCS-1200- colour code	1200 47 1/4"		
THCS-2400- colour code	2400 94 1/2"		

Note:  
- Sold in pairs.

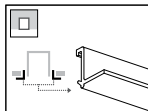

## Track Housing Colour Strip with Trim

Model	Length(mm/inch)	Colour	Material
THCST-600- colour code	600 23 5/8"		
THCST-700- colour code	700 27 9/16"		
THCST-800- colour code	800 31 1/2"	White(WHT) Black(BLK)	PC
THCST-900- colour code	900 35 7/16"	Gray(GRY)	
THCST-1000- colour code	1000 39 3/8"	Green(GRN)	
THCST-1100- colour code	1100 43 5/16"	Product code example: THCST-600- <u>WHT</u>	
THCST-1200- colour code	1200 47 1/4"		
THCST-2400- colour code	2400 94 1/2"		

Note:  
- Sold in pairs.

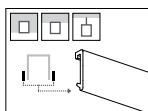

## i33 90° Track Housing Colour Strip

Model	Length(mm/inch)	Colour	Material
i33THCS-90-H- colour code	624 x 624 24 9/16"x24 9/16"	White(WHT) Black(BLK)	PC
i33THCS-90-V- colour code	635 x 635 25"x25"	Gray(GRY) Green(GRN)	
i33THCST-90-H- colour code	624 x 624 24 9/16"x24 9/16"	Product code example: i33THCS-90-H- <u>WHT</u>	
i33THCST-90-V- colour code	635 x 635 25"x25"		

Note:  
- Sold as a set.  
- Colour Strips (with Trim) for 90°Horizontal / Vertical Track Housing.  
- Not included with 90° track housing modules (please specify colour and trim type when ordering).

# mounting accessories

## INFINITY 2.0 SPECIFICATIONS

### Track Housing Mounting Screw

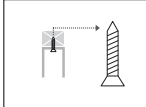

**Note:**

These screws are not included. Depending on the material the track housing is mounted on, the type of screw required may vary. Please purchase the screws locally.

**# of screws required per Track Housing:**

600	700	800	900	1000	1100	1200	2400	90°H	90°V
2	2	2	2	2	2	2	4	4	4

### i33 Recessed Mounting Holder

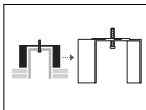

Model	Material
i33FRMH	AL

**Note:**

- Sold in pairs.
- For 2 ply trim mounting where mounting screws cannot be screwed into support beam. (refer to installation or system guide for details).
- Only to be used if light line is a single Track Housing Module.

**# of screws required per Track Housing:**

600	700	800	900	1000	1100	1200	2400	90°H	90°V
2	2	2	2	2	2	2	4	4	2

### Angle Bracket

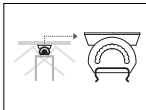

Model	Material
AB	AL

**Note:**

- Sold in pairs.

**# of Angle Brackets required per Track Housing:**

600	700	800	900	1000	1100	1200	2400
2	2	2	2	2	2	2	4

### Pole Mounting Bracket

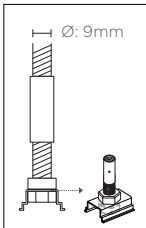

Model
PMB

**Note:**

- Sold in pairs.
- 1 bracket required for every meter of Track Housing. If light line is less than a meter, 2 brackets are required (one for each side).
- Can also be used for recessed mounting with false ceiling. (refer to installation or system guide for details).

**Includes:**

Bracket, nuts and connecting shaft. Does not include pole (9mm Ø pole required).

### Wire Mounting Bracket

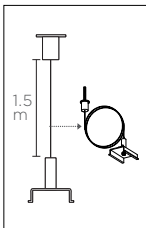

Model
WMB

**Note:**

- Sold in pairs.
- 1 bracket required for every meter of Track Housing. If light line is less than a meter, 2 brackets are required (one for each side).

**Includes:**

Bracket, ceiling mount, ceiling mount screw (for wood only, other screw types must be purchased locally), 1.5m cable & 1 nut.



# remote control\*

SPECIFICATIONS

\*Available 3rd quarter of 2016.

Wifi RF smart system

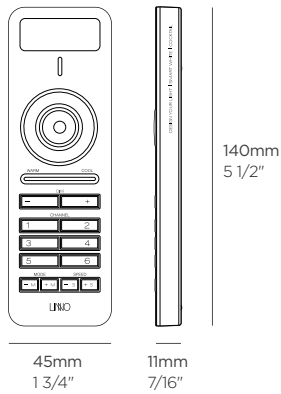

## Black remote control



Model	Operating Frequency	Range	Battery	Average Charge Time	Battery Life
RCB	2,400 - 2,483.5 MHz	20-25m	5V rechargeable	2.5 hours	6 hours of continuous use

Material	Battery Standby Period	Finish	Compatibility	Transmission	Included
ABS plastic	6 months	Black	Smart White Smart Cocktail	Radio frequency (Zigbee protocol)	USB charging cable, wall bracket, 1 screw